

# Replacement Installation Instructions

## 7292674 Faucet & Electronics Base without Airgap 7292682 Faucet & Electronics Base with Airgap (RO)

The connection from the faucet to your drinking water system may be different with this replacement faucet than the faucet originally supplied with the system.

### INSTALL REPLACEMENT FAUCET

1. Turn off water to the drinking water system.
2. Loosen old faucet hardware and slide old faucet up from the countertop.
3. Disconnect all tubing connections from faucet and discard the old faucet and hardware.
4. Remove the faucet from faucet base (if necessary) by giving it a 1/4 turn. Mount faucet base to sink hole until the faucet base is square against the sink surface. The rubber gasket should be between the sink surface and the faucet base.
5. Tighten the toggle bolts until the base is firmly mounted to the sink surface. Do not overtighten.
6. Feed the tubing up through the sink hole and faucet base.
7. Reattach the 3/8" blue tube to the corresponding fitting on the new faucet. See Fig 2 for RO system only.
8. RO system only: Snip off about 1/2" length of tubing from both the 1/4" red tubing and the 3/8" black tubing before reattaching to the barbs on the new faucet. See Fig. 2.
9. Work tubing back down and mount the faucet into faucet base with a 1/4" turn.
10. Turn water back on to the drinking water system.

### FAUCET ELECTRONICS

Inside the faucet base is a battery operated 6 month timer. See Fig. 1.

An amber LED indicator is also located in the front of the faucet base. This LED will flash continuously after 6 months has passed. This indicates that it is time to replace the battery, prefilters and postfilters.

### INSTALL BATTERY

To install battery, complete the following steps.

1. Loosen the screw on the right side of the faucet base. See Fig. 1.
2. Press the battery housing upwards from the front faucet base until it releases from the faucet base. See Fig. 1.
3. Replace the battery (Maxell CR 2032 or equivalent, not included). Place battery into the holder with the positive (+) side facing the back of the holder.
4. When the battery is first replaced it will flash six times and turn off. This indicates the battery is fully charged. After the six flashes the timer enters the 6 month time cycle.

**NOTE: If the LED repeatedly flashes two times, it is not a fully charged battery and will need to be replaced.**

5. Re-install the timer housing and firmly tighten the mounting screw. See Fig. 1.

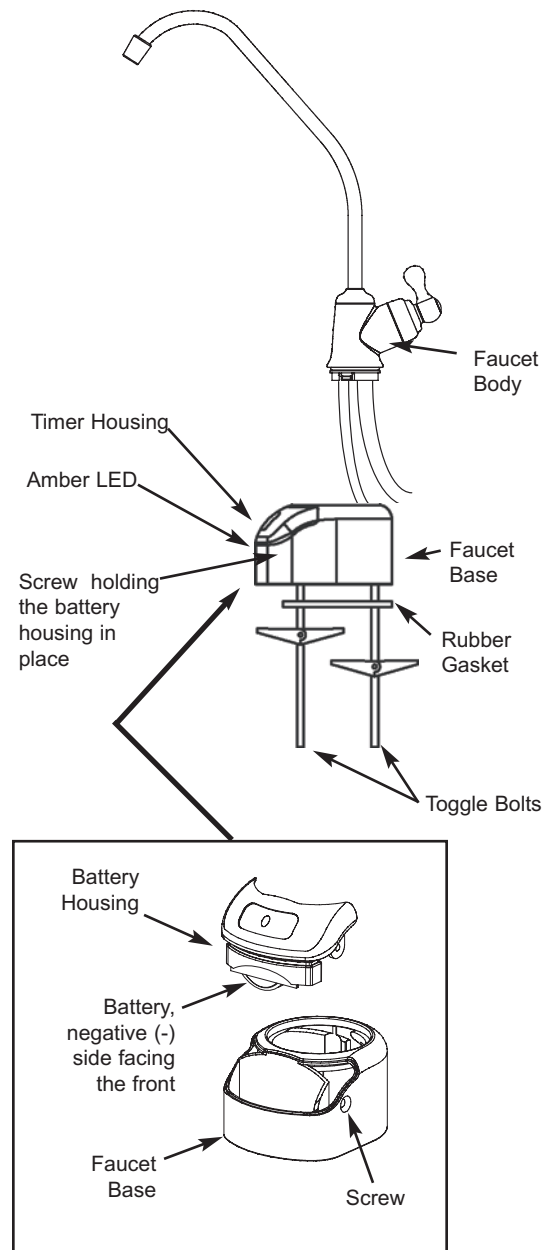

FIG. 1

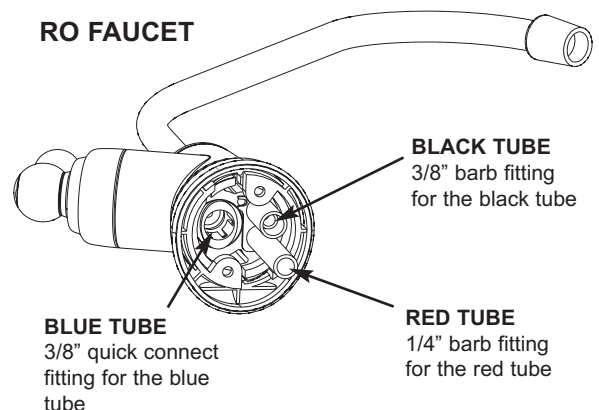

FIG. 2